

## INSPECTION

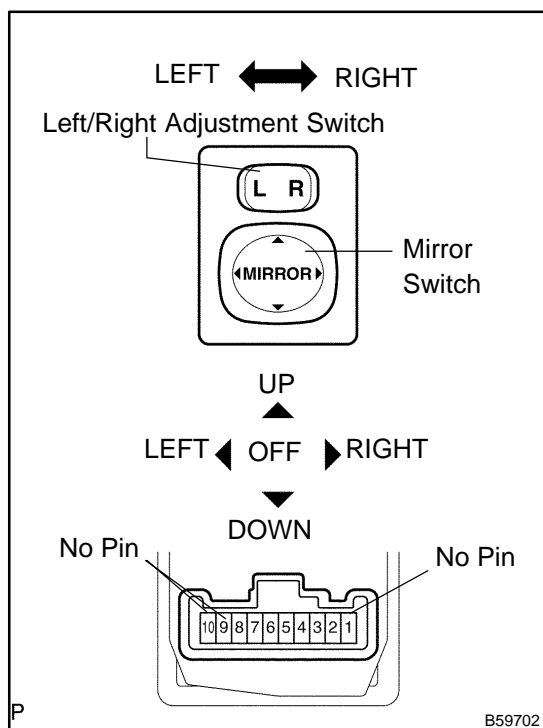

## 1. INSPECT OUTER MIRROR SWITCH ASSY

- (a) The L side of the left/right adjustment switch:  
Check the mirror switch resistance.

**Standard (Left side):**

Terminal Connection	Switch Condition	Specified Condition
4-8	UP	Below 1 Ω
6-7		
4-7	DOWN	
6-8		
5-8	LEFT	
6-7		
5-7	RIGHT	
6-8		

If the result is not as specified, replace the switch assy.

- (b) The R side of the left/right adjustment switch:  
Check the mirror switch resistance.

**Standard (Right side):**

Terminal Connection	Switch Condition	Specified Condition
3-8	UP	Below 1 Ω
6-7		
3-7	DOWN	
6-8		
2-8	LEFT	
6-7		
2-7	RIGHT	
6-8		

If the result is not as specified, replace the switch assy.

## 2. INSPECT OUTER REAR VIEW MIRROR ASSY LH

- (a) Disconnect the mirror connector.  
(b) Apply battery voltage to the mirror terminals and check operation of the mirror face, as shown in the table and illustration.

**Standard:**

Measurement Condition	Mirror Operation
Battery positive (+) → 5 (MV) Battery negative (-) → 3 (M+)	Turns upward (A)
Battery positive (+) → 3 (M+) Battery negative (-) → 5 (MV)	Turns downward (B)
Battery positive (+) → 3 (M+) Battery negative (-) → 1 (MH)	Turns left (C)
Battery positive (+) → 1 (MH) Battery negative (-) → 3 (M+)	Turns right (D)

If the result is not as specified, replace the mirror assy.

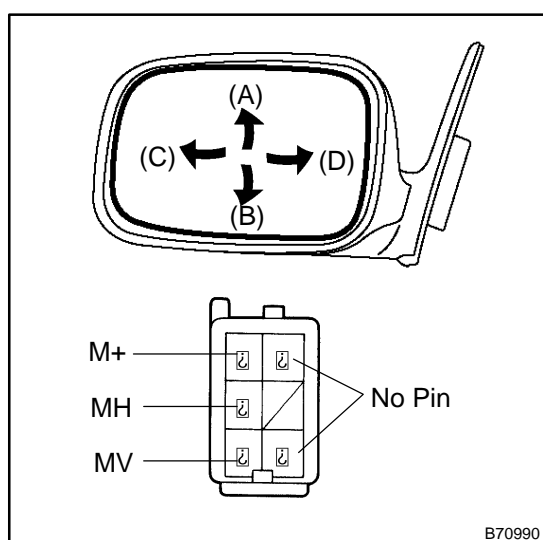

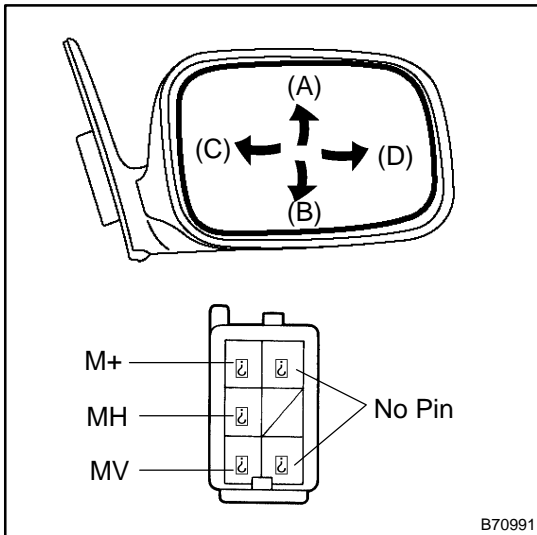

### 3. INSPECT OUTER REAR VIEW MIRROR ASSY RH

- (a) Disconnect the mirror connector.
- (b) Apply battery voltage to the mirror terminals and check operation of the mirror face, as shown in the table and illustration.

#### Standard:

Measurement Condition	Mirror Operation
Battery positive (+) → 5 (MV) Battery negative (-) → 3 (M+)	Turns upward (A)
Battery positive (+) → 3 (M+) Battery negative (-) → 5 (MV)	Turns downward (B)
Battery positive (+) → 1 (M+) Battery negative (-) → 3 (MH)	Turns right (D)
Battery positive (+) → 3 (MH) Battery negative (-) → 1 (M+)	Turns left (C)

If the result is not as specified, replace the mirror assy.