

ON-VEHICLE INSPECTION

1. HORN BUTTON ASSY (VEHICLES NOT INVOLVED IN COLLISION)

- (a) Perform a diagnostic system check (See page 05-453).
- (b) Perform a visual check which includes the following items with the horn button assy installed in the vehicle:
 - Cuts, minute cracks or marked discoloration on the horn button assy top surface and in the grooved portion.

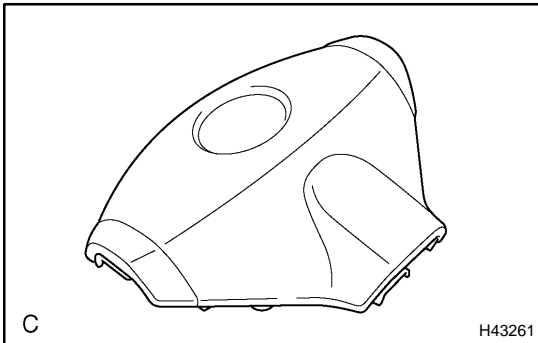

2. HORN BUTTON ASSY (VEHICLE INVOLVED IN COLLISION AND AIRBAG IS NOT DEPLOYED)

- (a) Perform a diagnostic system check (See page 05-453).
- (b) Perform a visual check which includes the following items with the horn button assy removed from the vehicle:
 - Cuts, minute cracks or marked discoloration on the horn button assy top surface and in the grooved portion.
 - Cracks or other damage in the connectors.
 - Deformation of the horn button assy.
 - Deformation of the horn button contact plate of the steering wheel assy.

HINT:

- If the horn button contact plate of the horn button assy is deformed, never repair it. Always replace the horn button assy with a new one.
- There should be no interference between the horn button assy and steering wheel assy, and the clearance should be uniform all the way around when the new horn button assy is installed on the steering wheel assy.

CAUTION:

For removal and installation procedures of the horn button assy, see "Replacement" on page 60-13, and be sure to follow the correct procedure.

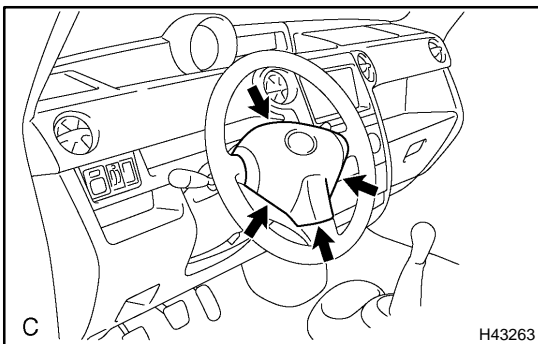
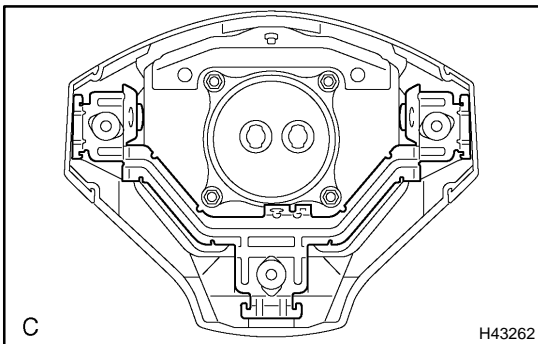

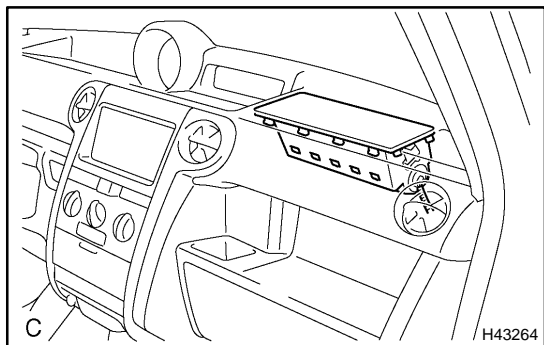

3. INSTRUMENT PANEL PASSENGER AIRBAG ASSY (VEHICLE NOT INVOLVED IN COLLISION)

- (a) Perform a diagnostic system check (See page 05-453).
- (b) Perform a visual check which includes the following items with the instrument panel passenger airbag assy installed in the vehicle:

Cuts, minute cracks or marked discoloration on the instrument panel around the instrument panel passenger airbag assy.

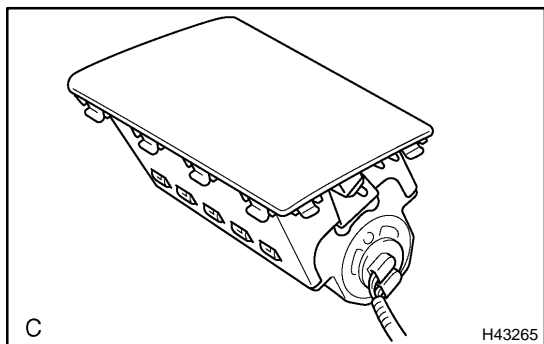

4. INSTRUMENT PANEL PASSENGER AIRBAG ASSY (VEHICLE INVOLVED IN COLLISION AND AIRBAG IS NOT DEPLOYED)

- (a) Perform a diagnostic system check (See page 05-453).
- (b) Perform a visual check which includes the following items with the instrument panel passenger airbag assy removed from the vehicle:

- Cuts, minute cracks or marked discoloration on the instrument panel passenger airbag assy.
- Cuts and cracks in wire harness, and chips in connector.
- Deformation or cracks on the instrument panel and instrument panel reinforcement.

HINT:

- If the instrument panel or instrument panel reinforcement is deformed or cracked, never repair it. Always replace it with a new one.
- There should be no interference between the instrument panel sub-assy upper and the instrument panel passenger airbag assy.

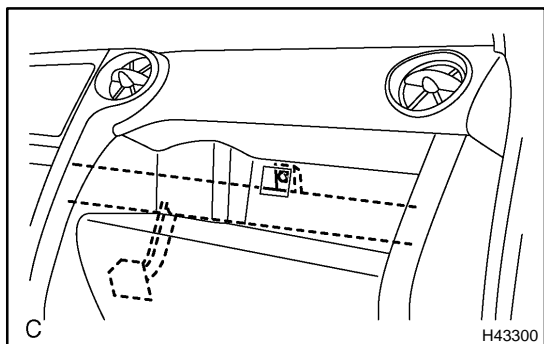

CAUTION:

For removal and installation procedures of the instrument panel passenger airbag assy, see "Replacement" on page 60-25, and be sure to follow the correct procedure.

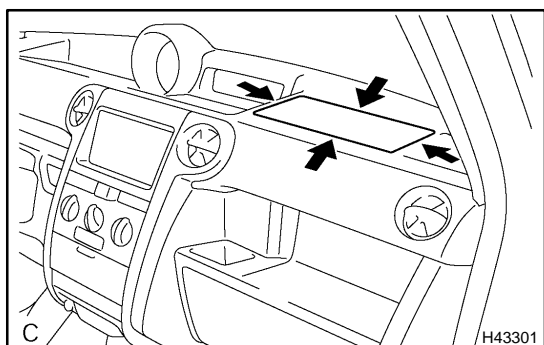

5. AIRBAG SENSOR ASSY CENTER (VEHICLE NOT INVOLVED IN COLLISION)

- (a) Perform a diagnostic system check (See page 05-453).

6. AIRBAG SENSOR ASSY CENTER (VEHICLE INVOLVED IN COLLISION AND AIRBAG IS NOT DEPLOYED)

- (a) Perform a diagnostic system check (See page 05-453).

7. AIRBAG SENSOR ASSY CENTER (VEHICLE INVOLVED IN COLLISION AND AIRBAG IS DEPLOYED)

- (a) Replace the airbag sensor assy center (See page 60-34).

8. AIRBAG FRONT SENSOR (VEHICLE NOT INVOLVED IN COLLISION)

- (a) Perform a diagnostic system check (See page 05-453).

9. AIRBAG FRONT SENSOR (VEHICLE INVOLVED IN COLLISION)

- (a) Perform a diagnostic system check (See page 05-453).
- (b) When the headlamp of the vehicle or its periphery is damaged, check if there is any damage to the airbag front sensor. If there are any defects mentioned below, replace the airbag front sensor with a new one:
 - Cracks, dents or chips in the case, or damage to the case plate.
 - Cracks, dents, chips and scratches in the connector.
 - Peeling of the label or damage to the serial number.

10. AIRBAG FRONT SENSOR (VEHICLE INVOLVED IN COLLISION AND AIRBAG IS DEPLOYED)

- (a) Replace the airbag front sensor assy (See page 60-36 and 60-37).

11. SEAT POSITION AIRBAG SENSOR (VEHICLES NOT INVOLVED IN COLLISION)

- (a) Perform a diagnostic system check (See page 05-453).

12. SEAT POSITION AIRBAG SENSOR (VEHICLE INVOLVED IN COLLISION)

- (a) Perform a diagnostic system check (See page 05-453).
- (b) Perform a visual check for damage to the seat position airbag sensor even if the airbag was not deployed:
 - Cracks, dents or chips in the case.
 - Cracks, dents, chips and scratches in the connector.

13. WIRE HARNESS AND CONNECTOR (VEHICLE NOT INVOLVED IN COLLISION)

- (a) Perform a diagnostic system check (See page 05-453).

14. WIRE HARNESS AND CONNECTOR (VEHICLE INVOLVED IN COLLISION)

- (a) Perform a diagnostic system check (See page 05-453).
- (b) Check for breaks in all wires of the SRS wire harness, and exposed conductor.
- (c) Check to see if the SRS wire harness connectors are cracked or chipped.

HINT:

The SRS wire harness is integrated with the engine room main wire, instrument panel wire, floor wire, harness assembly.