

## OVERHAUL

HINT:

COMPONENTS: See page 71-7 ,55-40

1. **DISCHARGE REFRIGERANT FROM REFRIGERATION SYSTEM(See page 55-23)**  
SST 07110-58060 (07117-58080, 07117-58090, 07117-78050, 07117-88060, 07117-88070, 07117-88080)
2. **DISCONNECT SUCTION HOSE SUB-ASSY(See page 55-32)**  
SST 09870-00015
3. **DISCONNECT LIQUID TUBE SUB-ASSY A(See page 55-32)**  
SST 09870-00025

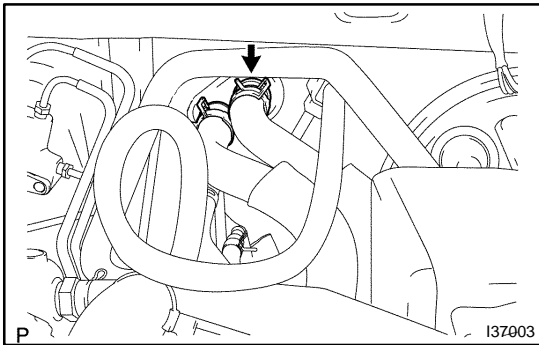

4. **DISCONNECT HEATER WATER INLET HOSE A**
  - (a) Using pliers, engage the claws of the clip and slide the clip and disconnect the heater water inlet hose A.

5. **DISCONNECT HEATER WATER OUTLET HOSE A(FROM HEATER UNIT)**

HINT:

Disconnect in the same way as for the heater water inlet hose A.

6. **REMOVE HEATER CONTROL KNOB(See page 55-25)**
7. **REMOVE INSTRUMENT CLUSTER FINISH PANEL SUB-ASSY CTR(See page 71-12)**
8. **REMOVE INSTRUMENT PANEL SUB-ASSY W/PASSENGER AIRBAG ASSY(See page 71-12)**

HINT:

Refer to the instructions for removal of the instrument panel sub-assy w/passenger air bag assy.

9. **REMOVE INSTRUMENT PANEL ASSY LOWER W/INSTRUMENT PANEL REINFORCEMENT (See page 71-21)**

HINT:

Refer to the instructions for removal of the instrument panel assy lower w/instrument panel reinforcement.

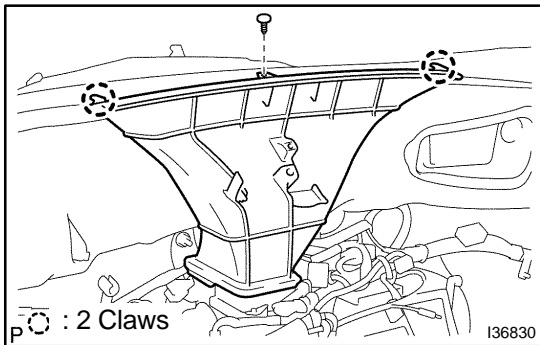

10. **REMOVE DEFROSTER NOZZLE ASSY**
  - (a) Remove the clip.
  - (b) Disengage the 2 claws and remove the defroster nozzle assy.

11. **REMOVE ECM(See page 10-17)**
12. **REMOVE AIR CONDITIONING BLOWER ASSY(See page 55-32)**

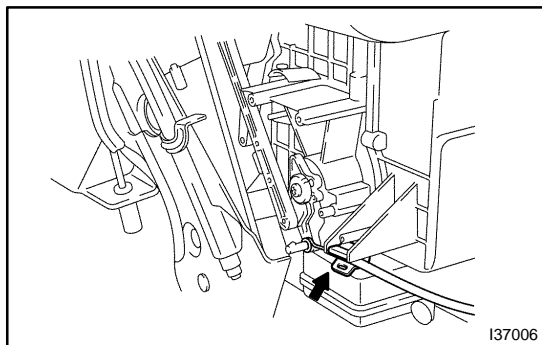

### 13. REMOVE DEFROSTER DAMPER CONTROL CABLE SUB-ASSY

- (a) Disconnect the outer cable.
- (b) Disconnect the inner cable and remove the defroster damper control cable sub-assy.

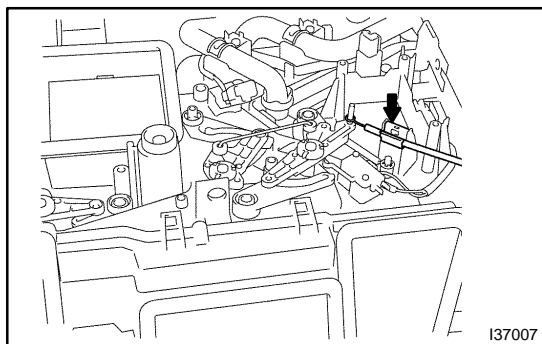

### 14. REMOVE AIRMIX DAMPER CONTROL CABLE SUB-ASSY

- (a) Disconnect the outer cable.
- (b) Disconnect the inner cable and remove the air mix damper control cable sub-assy.

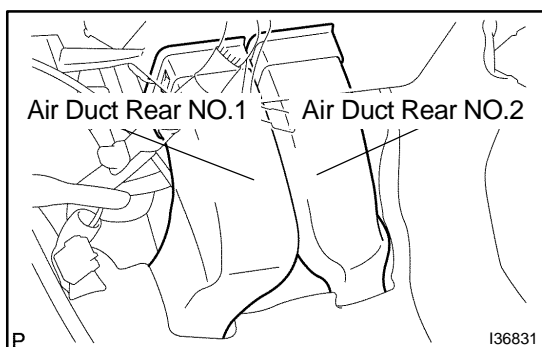

### 15. DISCONNECT AIR DUCT REAR NO.2

- (a) Disconnect the air duct rear No.2.

### 16. DISCONNECT AIR DUCT REAR NO.1

HINT:

Disconnect in the same way as for the air duct rear No.2.

### 17. REMOVE HEATER RADIATOR ASSY

- (a) Disconnect the 3 connectors.
- (b) Remove the bolt and separate the earth bolt from the PTC heater.

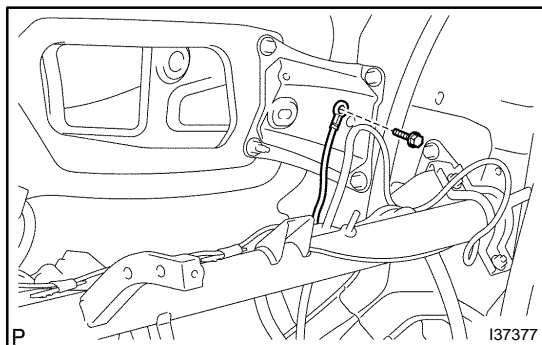

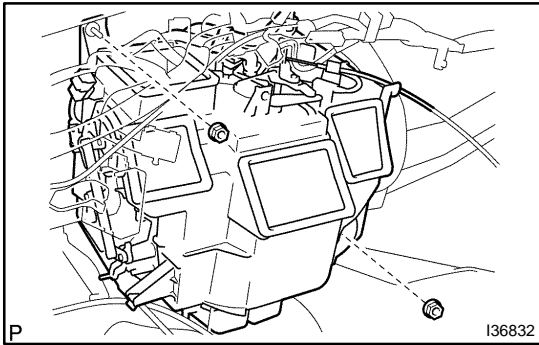

- (c) Remove the 2 nuts and the heater radiator assy.

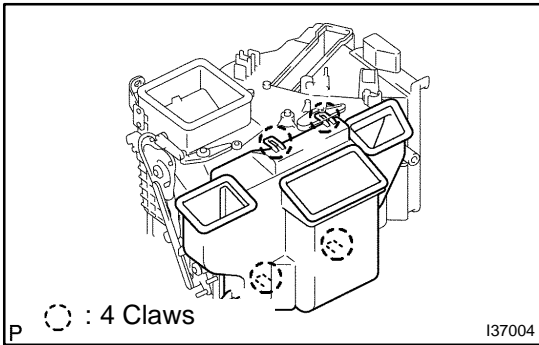

**18. REMOVE AIR DUCT ASSY**

- (a) Disengage the 4 claws and remove the air duct assy.

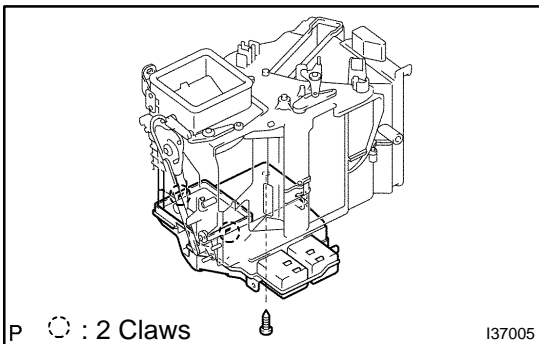

**19. REMOVE HEATER COVER**

- (a) Remove the screw.
- (b) Disengage the 2 claws and remove the heater cover.

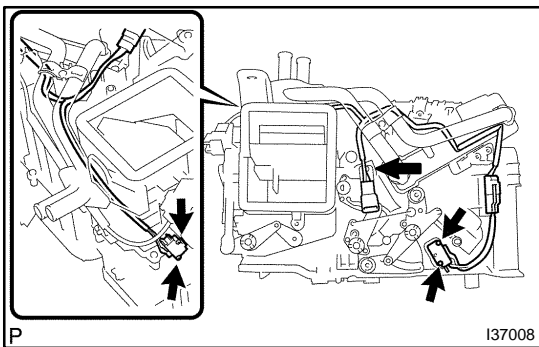

**20. REMOVE COOLER WIRING NO.2**

- (a) Remove the 5 screws and the cooler wiring No.2.

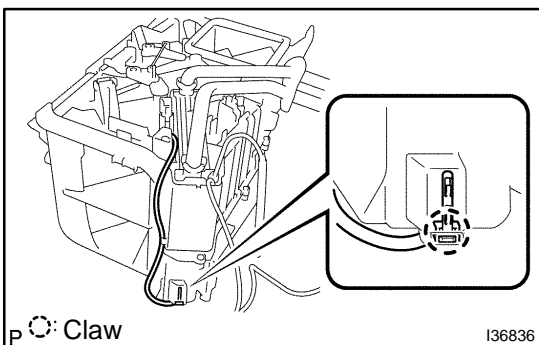

**21. REMOVE THERMISTOR ASSY**

- (a) Disengage the claw and remove the clamp.
- (b) Remove the thermistor assy.

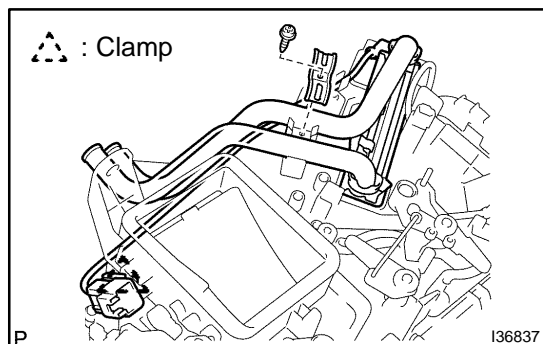
**22. REMOVE HEATER RADIATOR UNIT SUB-ASSY**

- (a) Remove the screw and the bracket.
- (b) Remove the clamp and disconnect the connector.
- (c) Remove the heater radiator unit sub-assy.

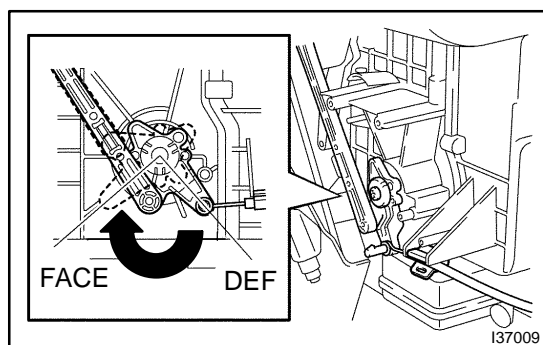
**23. INSTALL DEFROSTER DAMPER CONTROL CABLE SUB-ASSY**

- (a) Set the arm in the FACE position.
- (b) Install the inner cable end to the control lever with the arm in the FACE position.
- (c) Install the outer cable to the cable clamp while slightly pressing it in the direction of the arrow.

**NOTICE:**

- Be careful not to bend the cable wire.
- If the cable wire bends, the heater or boost ventilator control operation may be affected.

**HINT:**

Operating the mode control lever, check that it properly stops at both ends of FACE and DEF and no recoil is identified.

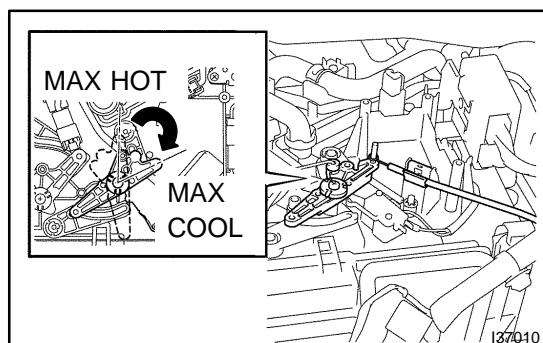
**24. INSTALL AIRMIX DAMPER CONTROL CABLE SUB-ASSY**

- (a) Set the arm in the MAX. COOL position.
- (b) Install the inner cable end to the control lever with the arm in the MAX. COOL position.
- (c) Install the outer cable to the cable clamp while slightly pressing it in the direction of the arrow.

**NOTICE:**

- Be careful not to bend the cable wire.
- If the cable wire bends, the heater or boost ventilator control operation may be affected.

**HINT:**

When operating the mode control lever, check that it properly stops at both ends of MAX. HOT and MAX. COOL and no recoil is identified.

**25. INSTALL ECM(See page 10-17)****26. INSTALL INSTRUMENT PANEL ASSY LOWER W/INSTRUMENT PANEL REINFORCEMENT (See page 71-21)****27. INSTALL INSTRUMENT PANEL SUB-ASSY W/PASSENGER AIRBAG ASSY(See page 71-12)****28. INSTALL INSTRUMENT CLUSTER FINISH PANEL SUB-ASSY CTR(See page 71-7)****29. INSTALL HEATER CONTROL KNOB(See page 55-25)****30. INSTALL LIQUID TUBE SUB-ASSY A(See page 55-32)****31. INSTALL SUCTION HOSE SUB-ASSY(See page 55-32)****32. ADD ENGINE COOLANT(See page 16-7)**

**33. CHARGE REFRIGERANT(See page 55-23)**

SST 07110-58060 (07117-58060, 07117-58070, 07117-58080, 07117-58090, 07117-78050, 07117-88060, 07117-88070, 07117-88080)

**Specified amount: 380 ± 30 g (13.9 ± 1.1 oz.)**

**34. WARM UP ENGINE(See page 55-23)****35. CHECK FOR ENGINE COOLANT LEAKS(See page 16-7)****36. INSPECT LEAKAGE OF REFRIGERANT(See page 55-23)**