

REPLACEMENT

1. REMOVE CLUTCH START SWITCH ASSY

- (a) Disconnect the clutch start switch assy connector.
- (b) Remove the 2 nuts and the clutch start switch assy with the bracket.
- (c) Remove the nut and clutch start switch assy from the bracket.

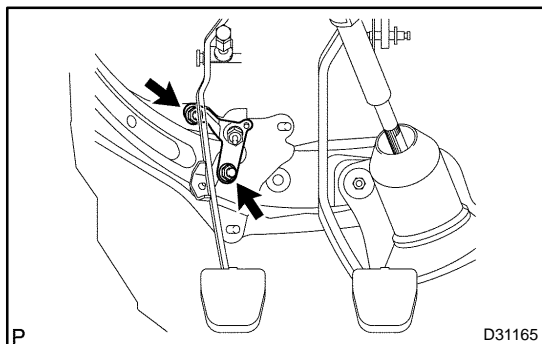

2. INSTALL CLUTCH START SWITCH ASSY

- (a) Install the clutch start switch assy with the nut.
Torque: 6.2 N·m (63 kgf·cm, 55 in·lbf)
- (b) Install the clutch start switch with the 2 nuts.
Torque: 6.2 N·m (63 kgf·cm, 55 in·lbf)
- (c) Connect the clutch start switch assy connector.

3. INSPECT CLUTCH START SWITCH ASSY (See page 42-21)