

FLOOR SHIFT PARKING LOCK CABLE ASSY (ATM)

REPLACEMENT

4011R-02

HINT:

- COMPONENTS: INSTRUMENT PANEL/METER (See page 71-7)
 - SUPPLEMENTAL RESTRAINT SYSTEM (See page 60-12)
 - STEERING COLUMN (See page 50-6)
1. **PRECAUTION** (See page 71-11)
 2. **SEPARATE BATTERY NEGATIVE TERMINAL**
 3. **PLACE FRONT WHEELS FACING STRAIGHT AHEAD**
 4. **REMOVE HORN BUTTON ASSY** (See page 50-8)
 5. **REMOVE STEERING WHEEL ASSY** (See page 50-8)
 6. **REMOVE STEERING COLUMN COVER** (See page 50-8)
 7. **REMOVE INSTRUMENT CLUSTER FINISH PANEL** (See page 71-11)
 8. **REMOVE INSTRUMENT CLUSTER FINISH PANEL SUB-ASSY LOWER CENTER** (See page 71-11)
 9. **REMOVE CONSOLE BOX REAR COVER**
 10. **REMOVE CONSOLE BOX CARPET**
 11. **REMOVE CONSOLE BOX SUB-ASSY REAR** (See page 40-37)

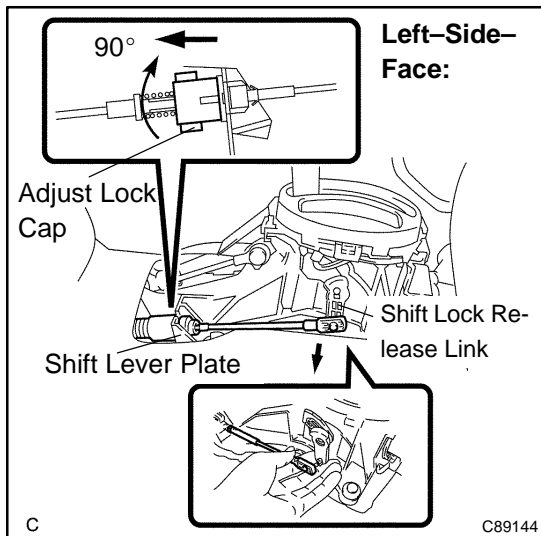

12. DISCONNECT FLOOR SHIFT PARKING LOCK CABLE ASSY

- (a) Rotate the adjust lock cap clockwise 90° facing the front of the vehicle, and release it.
- (b) Push the claw and disconnect the floor shift parking lock cable assy from the shift lock release link.

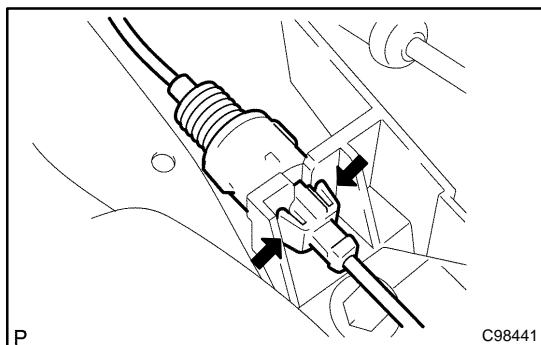

- (c) Using a screwdriver, disconnect the floor shift parking lock cable assy from the shift lever plate.

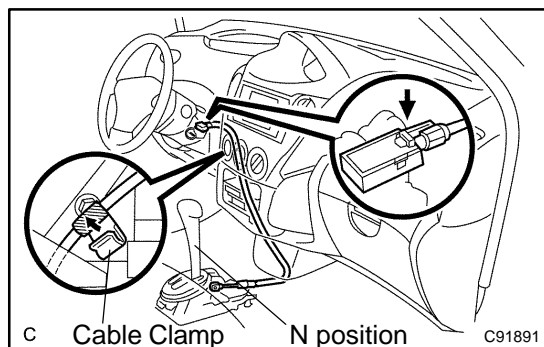

- (d) Disconnect the cable clamp.
- (e) Adjust the shift lever to the N position.
- (f) Disconnect the floor shift parking lock cable assy from the upper bracket.

13. CONNECT FLOOR SHIFT PARKING LOCK CABLE ASSY

- (a) Turn the ignition switch to the ACC or ON position.

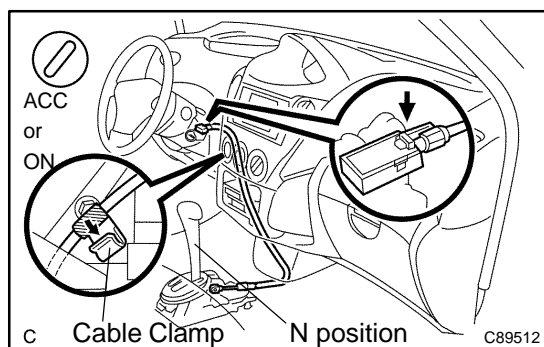

- (b) Connect the cable to the upper bracket.

HINT:

After installation, make sure that the lever pin is pulled by the cable and is stopped with the stopper.

- (c) Connect the cable clamp.
- (d) Shift the shift lever to N position.

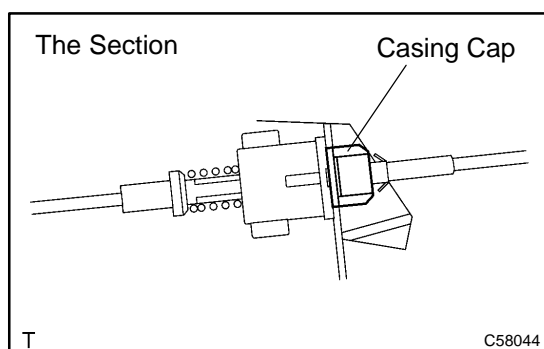

- (e) Insert the floor shift parking lock cable assy of the shift lever plate.
- (f) Insert the casing cap of the cable into the shift lever plate through-hole.

HINT:

Check that it is inserted securely.

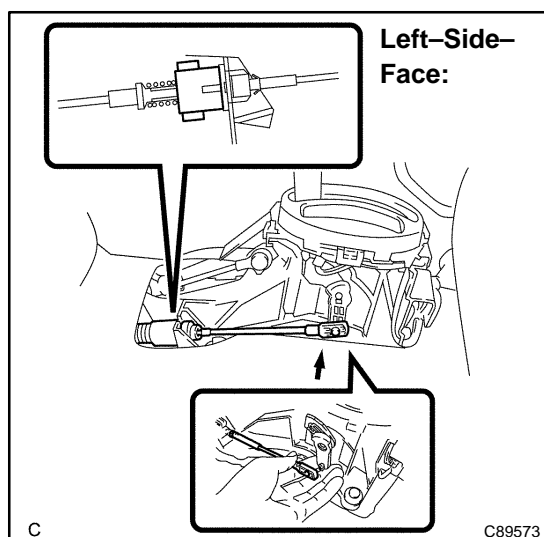

- (g) Insert the lever pin into the hole in the floor shift parking lock cable end.

HINT:

- At this time, ensure that the shift lever is in the N position.
- After installation, make sure that the lever pin is pulled by the floor shift parking lock cable and is stopped with the stopper.

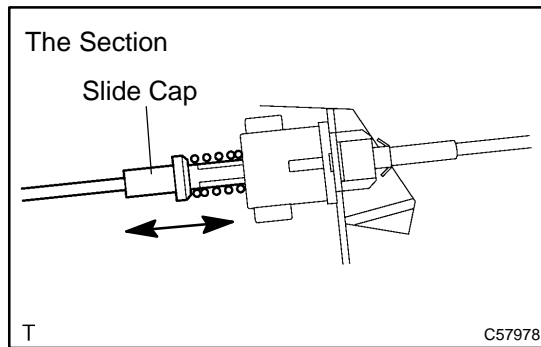

- (h) To check that the spring for automatic adjustment works properly, hold the slide cap and move it back and forth.

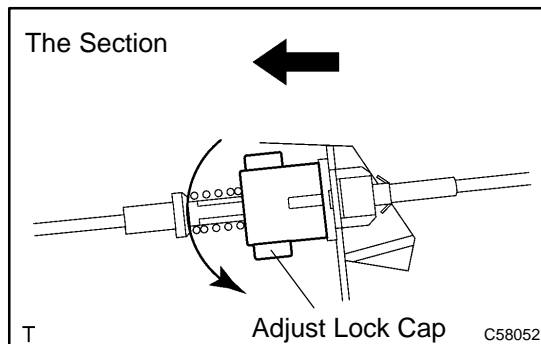

- (i) Rotate adjust lock cap shown in the illustration counter-clockwise by 90° facing the front of the vehicle.

HINT:

- Install the floor shift parking lock cable on the shift lever side with the key in the ACC position.
- Make sure the slide amount of the spring for automatic adjustment is 8 mm (0.31 in.).

14. **INSTALL CONSOLE BOX SUB-ASSY REAR** (See page [40-37](#))
15. **INSTALL CONSOLE BOX CARPET**
16. **INSTALL CONSOLE BOX REAR COVER**
17. **INSTALL INSTRUMENT CLUSTER FINISH PANEL SUB-ASSY LOWER CENTER** (See page [71-11](#))
18. **INSTALL INSTRUMENT CLUSTER FINISH PANEL**
19. **INSTALL STEERING COLUMN COVER** (See page [50-8](#))
20. **INSTALL STEERING WHEEL ASSY** (See page [50-8](#))
21. **STEERING WHEEL CENTER POINT**
22. **INSTALL HORN BUTTON ASSY** (See page [50-8](#))
23. **CONNECT BATTERY NEGATIVE TERMINAL**
24. **INSPECT HORN BUTTON ASSY** (See page [50-8](#))
25. **INSPECT SRS WARNING LIGHT** (See page [60-9](#))
26. **CHECK KEY INTERLOCK OPERATION** (See page [40-32](#))