

REPLACEMENT

1. REMOVE SHIFT LEVER KNOB SUB-ASSY (M/T TRANSAXLE)
2. REMOVE CONSOLE BOX REAR COVER
3. REMOVE CONSOLE BOX CARPET

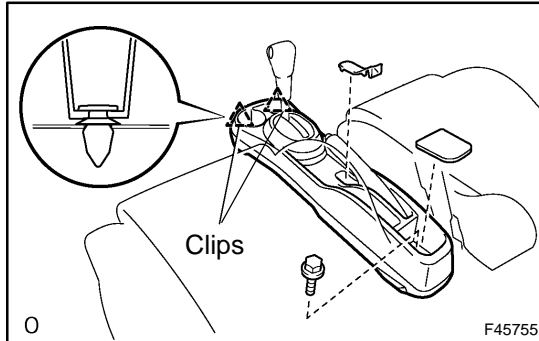

4. REMOVE CONSOLE BOX ASSY REAR

- (a) Remove the screw.
- (b) Using a clip remover, disengage the 2 clips, and remove the console box assy rear.

5. REMOVE WIRE ADJUSTING NUT NO.1

- (a) Remove the lock nut and wire adjusting nut No.1.

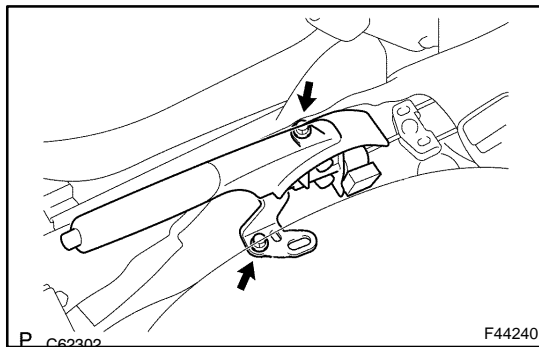

6. REMOVE PARKING BRAKE LEVER SUB-ASSY

- (a) Disconnect the parking brake switch connector.
- (b) Remove the 2 bolts and the parking brake lever.

7. REMOVE PARKING BRAKE SWITCH ASSY

- (a) Remove the screw and the parking brake switch.

8. INSTALL PARKING BRAKE SWITCH ASSY

- (a) Install the parking brake switch with the screw.

9. INSTALL PARKING BRAKE LEVER SUB-ASSY

- (a) Connect the parking brake pull rod to the lever, and install the lock nut and wire adjusting nut No.1.
- (b) Install the parking brake lever with the 2 bolts.

Torque: 13 N·m (127 kgf·cm, 9 ft·lbf)

- (c) Connect the parking brake switch connector.

10. CHECK PARKING BRAKE LEVER TRAVEL (See page 33-2)

11. ADJUST PARKING BRAKE LEVER TRAVEL (See page 33-2)