

OIL PUMP SEAL REPLACEMENT

141FY-01

1. REMOVE FAN AND GENERATOR V BELT (See page 14-5)
2. REMOVE FRONT WHEEL RH
3. REMOVE ENGINE UNDER COVER RH (See page 19-3)
4. REMOVE VANE PUMP V BELT (See page 14-5)
5. REMOVE CRANKSHAFT DAMPER SUB-ASSY (See page 14-68)

SST 09213-58012 (91111-50845), 09330-00021, 09950-50013 (09951-05010, 09952-05010, 09953-05020, 09954-05021)

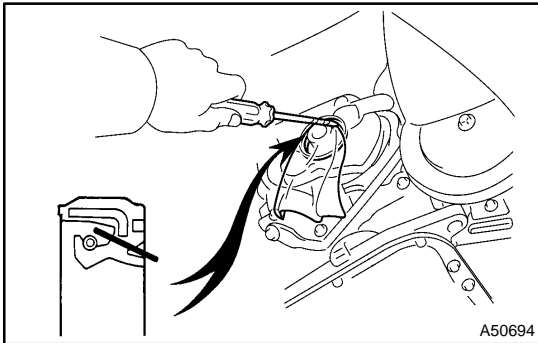

6. REMOVE OIL PUMP SEAL

- (a) Using a knife, cut off the oil seal lip.
- (b) Using a screwdriver with the tip wrapped in tape, pry out the oil seal.

NOTICE:

After removal, check if the crankshaft is not damaged. If it is damaged, smooth the surface with 400 – grit sandpaper.

7. INSTALL OIL PUMP SEAL

- (a) Apply multi-purpose grease to a new oil seal lip.

NOTICE:

Keep the lip free of foreign objects.

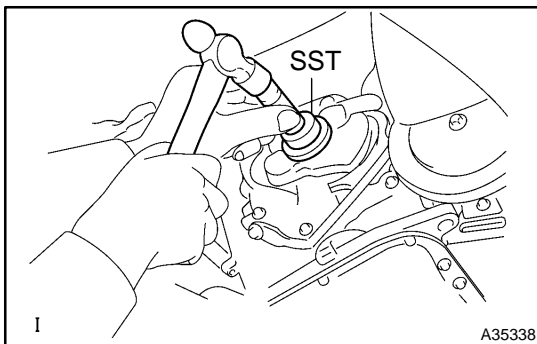

- (b) Using SST and a hammer, tap in the oil seal until its surface is flush with the oil pump edge.

SST 09223-22010

NOTICE:

- Be careful not to tap the oil seal at an angle.
- Wipe off extra grease on the crankshaft.

8. INSTALL CRANKSHAFT DAMPER SUB-ASSY (See page 14-68)

SST 09330-00021, 09213-58012 (91111-50845)

9. INSTALL VANE PUMP V BELT

- (a) Temporarily install the V-ribbed belt on each pulley.

10. INSTALL FAN AND GENERATOR V BELT

- (a) Temporarily install the V-ribbed belt on each pulley.

11. ADJUST FAN AND GENERATOR V BELT (See page 14-5)

12. ADJUST VANE PUMP V BELT (See page 14-5)

13. INSPECT DRIVE BELT DEFLECTION AND TENSION (See page 14-1)

14. INSTALL ENGINE UNDER COVER RH**Torque:****5.0 N·m (51 kgf·cm, 44 in·lbf) for Bolt****5.0 N·m (51 kgf·cm, 44 in·lbf) for Nut****15. ADD ENGINE OIL****16. CHECK FOR ENGINE OIL LEAKS**