

REPLACEMENT

1. DRAIN ENGINE COOLANT (See page 16-7)
2. REMOVE AIR CLEANER ASSY (See page 10-8)
3. SEPARATE ACCELERATOR CONTROL CABLE ASSY (See page 10-8)
4. REMOVE TRANSMISSION OIL LEVEL GAGE SUB-ASSY (A/T TRANSAXLE)
5. REMOVE TRANSMISSION OIL FILLER TUBE SUB-ASSY (A/T TRANSAXLE)
(See page 10-8)

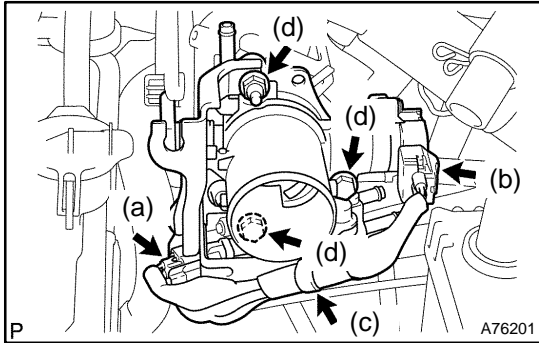

6. SEPARATE THROTTLE BODY ASSY

- (a) Disconnect the ISC valve connector.
- (b) Disconnect the throttle position sensor connector.
(M/T TRANSAXLE)
- (c) Remove the wire harness clamp.
- (d) Remove the bolt and 2 nuts, then remove the accelerator control cable bracket and throttle body.
- (e) Remove the gasket from the intake manifold.

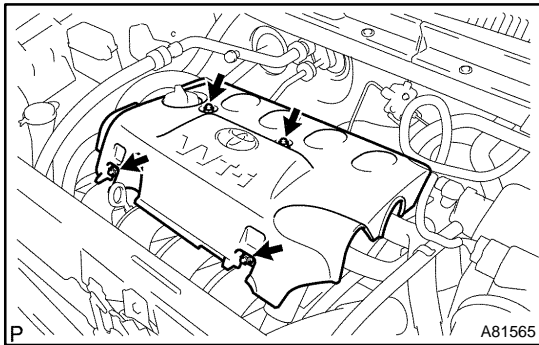

7. REMOVE CYLINDER HEAD COVER NO.2

- (a) Remove the 4 nuts and cylinder head cover.

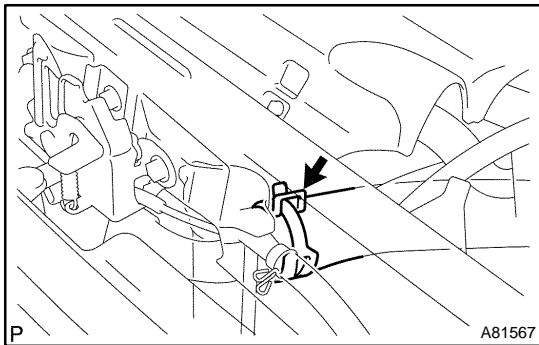

8. DISCONNECT RADIATOR HOSE INLET

9. REMOVE OIL LEVEL GAGE SUB-ASSY

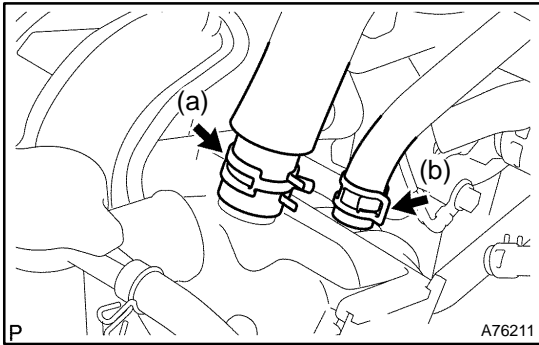

- 10. REMOVE INTAKE MANIFOLD**
 (a) Disconnect the ventilation hose.
 (b) Disconnect the union to connector tube hose.

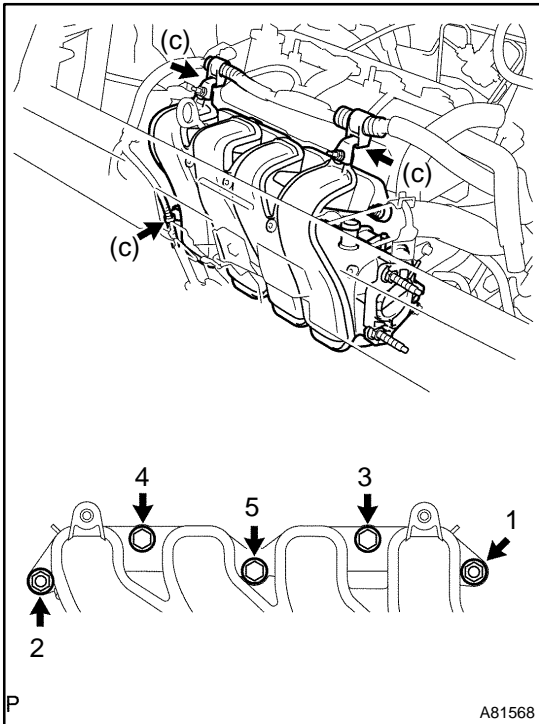

- (c) Remove the 3 wire harness clamps.
 (d) In order to remove the intake manifold, using several steps, remove the 3 bolts and 2 nuts in the sequence shown in the illustration.
 (e) Remove the gasket from the intake manifold.

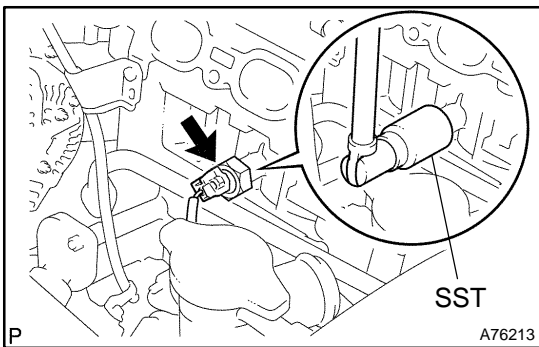

- 11. REMOVE KNOCK SENSOR**
 (a) Disconnect the knock sensor connector.
 (b) Using SST, remove the knock sensor.
 SST 09816-30010

- 12. INSTALL KNOCK SENSOR**
 (a) Using SST, install the knock sensor.
 SST 09816-30010
Torque: 44 N·m (450 kgf·cm, 32 ft·lbf)
 (b) Connect the knock sensor connector.

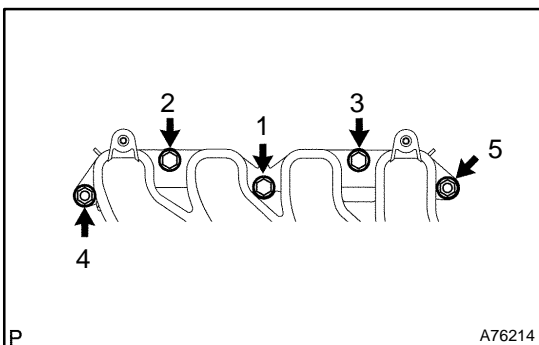

- 13. INSTALL INTAKE MANIFOLD**
 (a) Install a new gasket to the intake manifold.
 (b) Install the intake manifold with the 3 bolts and 2 nuts. Using several steps, tighten the bolts and nuts uniformly in the sequence shown in the illustration.
Torque: 30 N·m (306 kgf·cm, 22 ft·lbf)
 (c) Install the 3 wire harness clamps.
 (d) Connect the union to connector tube hose.
 (e) Connect the ventilation hose.

14. INSTALL OIL LEVEL GAGE SUB-ASSY
15. CONNECT RADIATOR HOSE INLET

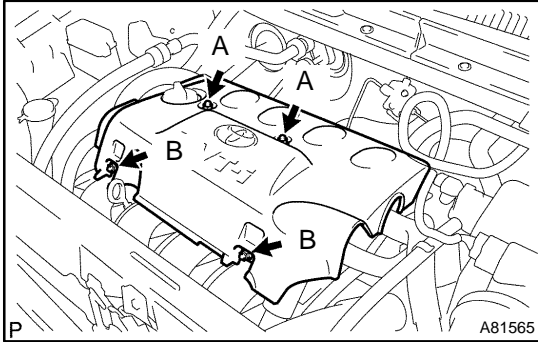

16. **INSTALL CYLINDER HEAD COVER NO.2**
 - (a) Install the cylinder head cover.
 - (b) First tighten nut A, then tighten nut B.**Torque: 7.0 N·m (71 kgf·cm, 62 in.·lbf)**

17. **INSTALL THROTTLE BODY ASSY**
 - (a) Install a new gasket to the intake manifold.
 - (b) Install the throttle body and accelerator control cable bracket with the bolt and 2 nuts.
Torque: 30 N·m (306 kgf·cm, 22 ft·lbf)
 - (c) Install the wire harness clamp.
 - (d) Connect the throttle position sensor connector. (M/T TRANSAXLE)
 - (e) Connect the ISC valve connector.
18. **INSTALL TRANSMISSION OIL FILLER TUBE SUB-ASSY (A/T TRANSAXLE)**
(See page 10-8)
19. **INSTALL TRANSMISSION OIL LEVEL GAGE SUB-ASSY (A/T TRANSAXLE)**
20. **INSTALL ACCELERATOR CONTROL CABLE ASSY (See page 10-8)**
21. **INSTALL AIR CLEANER ASSY (See page 10-8)**
22. **ADD ENGINE COOLANT (See page 16-7)**
23. **CHECK FOR ENGINE COOLANT LEAKS (See page 16-1)**